

# COMMON MODE TOROIDS

## TRF SERIES

TRF 2516, 3015, 4222, 5927

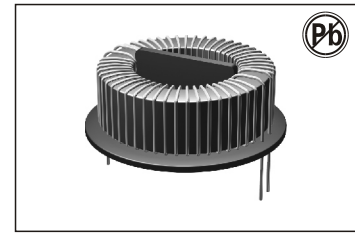

### FEATURES:

- Low Profile series common mode toroids meets critical filtering requirements where installation profiles are at a premium.
- UL94-VO materials used. Toroids meet IEC, VDE and CSA specifications.

### OPTIONS:

- Bulk packaging is Standard Custom available
- Tolerance:10% is standard, tighter tolerances available.

### COMMON APPLICATIONS:

- Power Line Filters
- Suppress EMI in Switch Mode Supplies
- Linear Power Supply Filters

## PHYSICAL CHARACTERISTICS

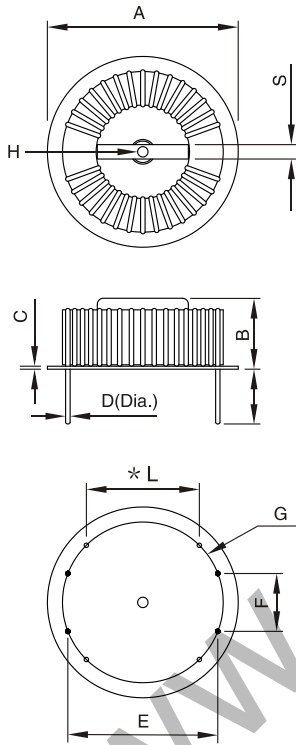

\* L: standoffs 1.58 x 0.81-4places

Part No.	A max	B max	C Typ	D (dia)	E	F Typ	G (dia)	S Typ	H dia. ±0.13
TRF-2516	25.65	15.95	0.81	see table	20.88	7.62	22.10	3.05	N/A
TRF-3015	31.09	14.91	0.81	see table	27.18	8.38	27.94	3.05	N/A
TRF-4222	43.43	22.15	0.81	see table	35.92	12.7	38.10	3.05	N/A
TRF-5927	58.93	27.23	0.81	see table	52.32	12.7	53.85	3.05	N/A

## STANDARD SPECIFICATIONS

TRF-2516 SERIES PART No.	RATED CURRENT AMPS (RMS)	INDUCTANCE 10KHz (mH) -0 ± 60%	MAX.DCR (Ω) @+20°C	LEAKAGE INDUCTANCE (μH) Typ	"D" Dia. (IN) NOM
TRF-2516-2.7-1	1.0	2.7	0.07	19	0.51
TRF-2516-4.7-1	1.0	4.7	0.10	35	0.51
TRF-2516-10-1	1.0	10.1	0.12	62	0.51
TRF-2516-1.0-1	2.0	1.0	0.026	7.5	0.64
TRF-2516-3.9-1	2.0	3.9	0.050	27	0.64
TRF-2516-6.8-1	2.0	6.8	0.068	44	0.64

TRF-3015 SERIES PART No.	RATED CURRENT AMPS (RMS)	INDUCTANCE 10KHz (mH) -0 ± 60%	MAX.DCR (Ω) @+20°C	LEAKAGE INDUCTANCE (μH) Typ	"D" Dia. (IN) NOM
TRF-3015-4.7-2	2.0	4.7	0.084	56	0.64
TRF-3015-8.2-2	2.0	8.2	0.09	59	0.64
TRF-3015-15-2	2.0	15.0	0.11	98	0.64
TRF-3015-1.2-4	4.0	1.2	0.036	17	0.74
TRF-3015-2.2-4	4.0	2.2	0.040	18	0.74
TRF-3015-3.9-4	4.0	3.9	0.054	22	0.74

TRF-4222 SERIES PART No.	RATED CURRENT AMPS (RMS)	INDUCTANCE 10KHz (mH) -0 ± 60%	MAX.DCR (Ω) @+20°C	LEAKAGE INDUCTANCE (μH) Typ	"D" Dia. (IN) NOM
TRF-4222-18.0-2	2.0	18.0	0.19	209	0.64
TRF-4222-27.0-2	2.0	27.0	0.25	375	0.64
TRF-4222-56.0-2	2.0	56.0	0.34	604	0.64
TRF-4222-8.2-4	4.0	8.2	0.10	96	0.74
TRF-4222-15.0-4	4.0	15.0	0.14	179	0.74
TRF-4222-6.8-6	6.0	6.8	0.08	7	0.81

TRF-5927 SERIES PART No.	RATED CURRENT AMPS (RMS)	INDUCTANCE 10KHz (mH) -0 ± 60%	MAX.DCR (Ω) @+20°C	LEAKAGE INDUCTANCE (μH) Typ	"D" Dia. (IN) NOM
TRF-5927-39-2	2.0	39.0	0.32	552	0.64
TRF-5927-62-2	2.0	62.0	0.39	440	0.64
TRF-5927-120-2	2.0	120.0	0.49	925	0.64
TRF-5927-18-4	4.0	18.0	0.17	252	0.74
TRF-5927-33-4	4.0	33.0	0.23	486	0.74
TRF-5927-15-6	6.0	15.0	0.12	193	0.81

## ELECTRONICAL SCHEMATIC

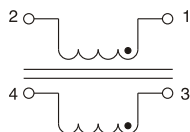

All dimensions in mm