

MAGNETIC SHIELDED SURFACE-MOUNT POWER INDUCTORS

SDRH5020, 5028 SERIES

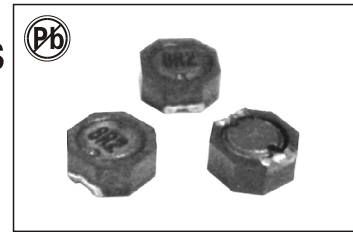

FEATURES:

- Magnetically Shielded Structure
- Low DC Resistance
- Large current up to 2.7A
- Excellent Mechanical Strength
- High Reliability and Excellent Solderability
- Low and square Profile
- High heat resistance

OPTIONS:

- Packaging: Tape & Reel is standard (Qty: 2500 pcs)
Bulk packaging available for smaller quantities
- Tolerance: 10% and 5% is standard, tighter tolerances available

COMMON APPLICATIONS:

- VCRs, Notebook, DC/DC Converters
- Video Digital Cameras
- Communication System
- Automotive Systems Power supplier
- LCD PDP Televisions
- Hard Disk Drives, Topset, XDSL
- Network Systems
- Computer Peripheral Equipment

ELECTRICAL CHARACTERISTICS

Part Number	L (μH)	Test Freq (kHz)	DCR Ω Max	IDC Max A
SDRH5020-1R2M	1.2	100	0.044	2.15
SDRH5020-2R2M	2.2	100	0.059	1.63
SDRH5020-3R3M	3.3	100	0.062	1.50
SDRH5020-4R7M	4.7	100	0.087	1.14
SDRH5020-6R8M	6.8	100	0.105	0.95
SDRH5020-8R2M	8.2	100	0.139	0.90
SDRH5020-100M	10	1	0.150	0.76
SDRH5020-150M	15	1	0.210	0.63
SDRH5020-220M	22	1	0.275	0.56
SDRH5020-330M	33	1	0.455	0.44
SDRH5020-470M	47	1	0.730	0.35
SDRH5020-680M	68	1	0.935	0.30
SDRH5020-101M	100	1	1.500	0.23
SDRH5020-121M	120	1	1.910	0.22
SDRH5020-151M	150	1	2.680	0.21
SDRH5020-181M	180	1	3.040	0.20
SDRH5020-221M	220	1	3.520	0.195
SDRH5020-271M	270	1	4.380	0.193
SDRH5020-331M	330	1	5.560	0.190
SDRH5020-471M	470	1	7.820	0.180

Part Number	L (μH)	Test Freq (kHz)	DCR Ω Max	IDC Max A
SDRH5028-1R0M	1.0	100	0.015	4.00
SDRH5028-2R2M	2.2	100	0.029	2.41
SDRH5028-3R3M	3.3	100	0.034	2.36
SDRH5028-4R7M	4.7	100	0.045	1.87
SDRH5028-5R6M	5.6	100	0.052	1.60
SDRH5028-6R8M	6.8	100	0.068	1.51
SDRH5028-100M	10	1	0.090	1.33
SDRH5028-150M	15	1	0.142	1.05
SDRH5028-220M	22	1	0.208	0.86
SDRH5028-330M	33	1	0.257	0.72
SDRH5028-470M	47	1	0.352	0.62
SDRH5028-680M	68	1	0.525	0.51
SDRH5028-101M	100	1	0.801	0.43
SDRH5028-121M	120	1	0.850	0.34
SDRH5028-151M	150	1	1.100	0.26
SDRH5028-181M	180	1	1.190	0.24
SDRH5028-221M	220	1	1.530	0.20

Note: 1. K= ± 10%, M= ± 20%, N= ± 30%

PHYSICAL CHARACTERISTICS & TECHNICAL INFORMATION

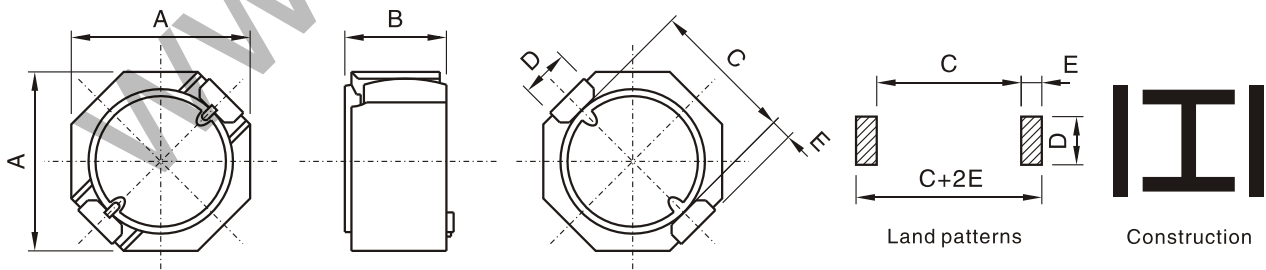

DIMENSIONS IN: mm

Part number	A	B	C	D	E	C+2E
SDRH5020	5.00 ± 0.3	2.0Max	4.2	1.6	0.6	5.4
SDRH5028	5.30 ± 0.3	2.8Max	4.2	1.6	0.6	5.4

- Inductor Testing: HP4284A (Equivalent acceptable)
DCR: QuadTech 1880 Milliohmmer Q – HP4342A – SRF-HP4191A IDCMax
Current is decreased 10% against its initial value
 - Operating temperature: -40°C to +105°C
 - Storage temperature: -40°C to +105°C
 - Solder methods: Vapor Phase, Infrared Reflow
 - Resistance to soldering heat: 260°C for 10 seconds
 - Solvent resistance: Conforms to MIL-STD-202E
 - Marking: Inductance & Tolerance
- Note: All specifications subject to change without notice.