



Female Header 2.54mm Straddle / Press Fit / Stripped Type

Specifications

Current Rate: 3 AMP
 Insulation Resistance: 1000MΩ Min.
 Contact Resistance: 20mΩ Max.
 Dielectric Voltage: 1000V AC for one minute
 Operation Temperature: -40°C to +105°C

Material

Insulator: P.B.T or Hi-Temp. Thermoplastic or LCP, UL 94V-0
 Terminal: Copper Alloy
 Plating: Gold Plated

ORDER INFORMATION

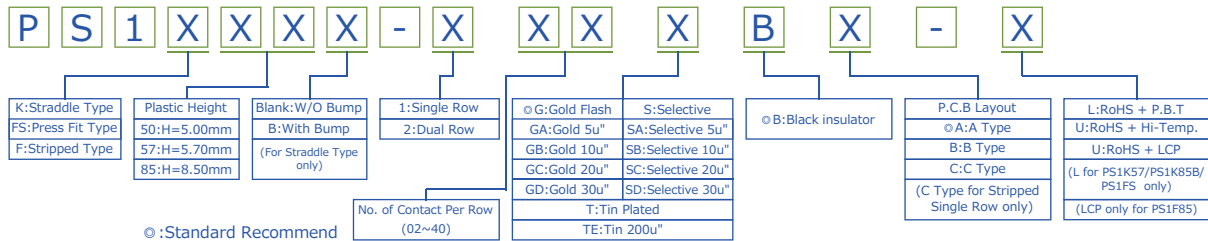

Female Header 2.54mm 2 Row H=5.0mm Straddle Type With Bump

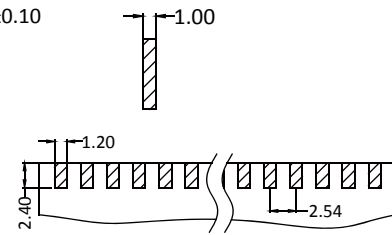
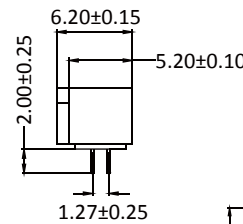
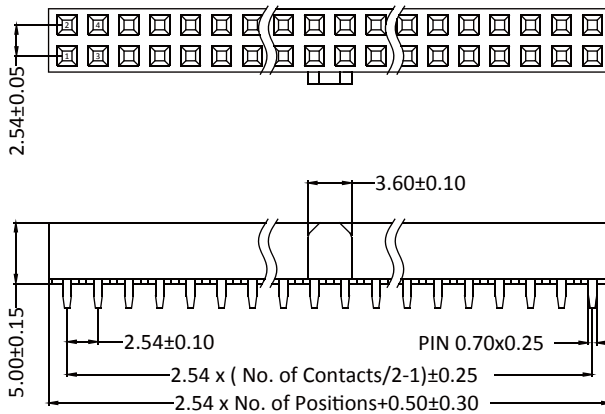

Recommended P.C.B Layout (TOP Side)
 (PCB BOARD TOLERANCE ±0.05)

Part No.: PS1K50B-2XX-U

Female Header 2.54mm 2 Row H=5.7mm Straddle Type

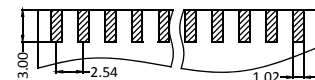
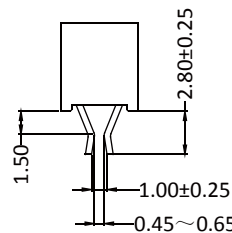
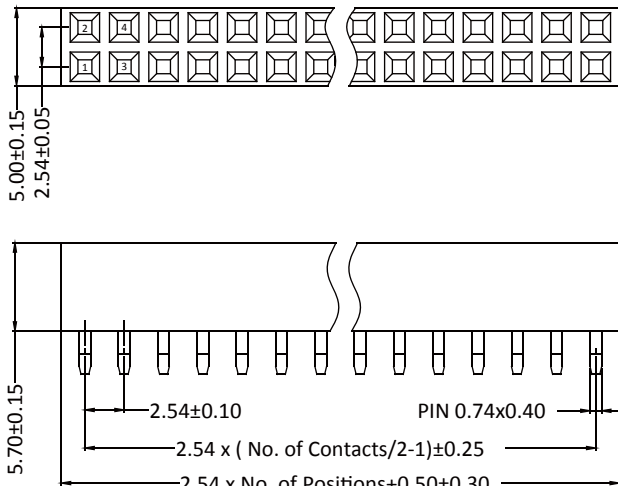

Recommended P.C.B Layout (TOP Side)
 (PCB BOARD TOLERANCE ±0.05)

Part No.: PS1K57-2XX-L

F

Female Header 2.54mm



ROHS