

Core **RM8**

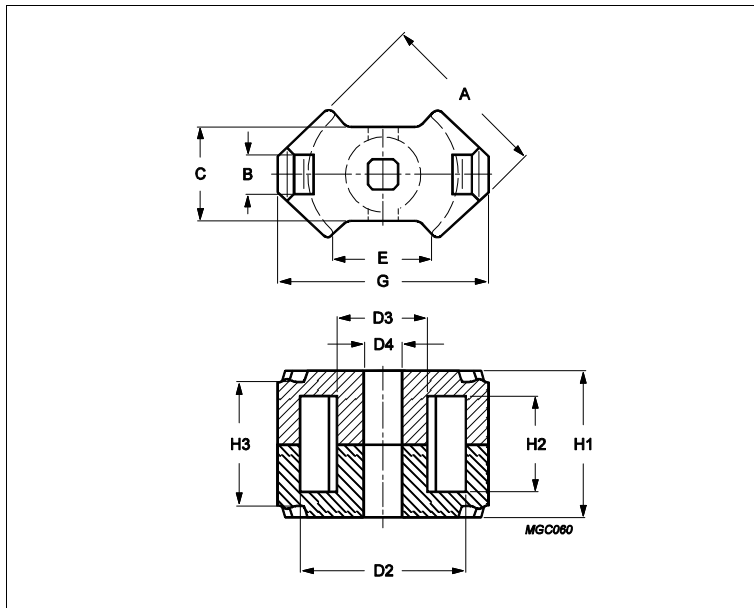

Effective parameters			
	Parameter	Value	Unit
$\Sigma(I/A)$	core factor (C1)	0.683	mm ⁻¹
Ve	effective volume	1850	mm ³
Le	effective length	35.5	mm
Ae	effective area	52	mm ²
Amin	minimum area	39.5	mm ²
m	RM8	≈ 11	g/set

Dimensions for product: RM8						
	Nom	Tol +	Tol -	Max	Min	Unit
A	19.70	0.00	0.80	19.70	18.90	mm
B	5.00	0.20	0.00	5.20	5.00	mm
C	11.00	0.00	0.50	11.00	10.50	mm
D2	17.00	0.60	0.00	17.60	17.00	mm
D3	8.55	0.00	0.30	8.55	8.25	mm
D4	4.40	0.20	0.00	4.60	4.40	mm
E					9.50	mm
G	23.20	0.00	0.90	23.20	22.30	mm
H1	16.40	0.10	0.10	16.50	16.30	mm
H2	10.80	0.40	0.00	11.20	10.80	mm
H3	14.30	0.20	0.20	14.50	14.10	mm

Inductance factor				
Material	Value	Tol +	Tol -	Unit
3D3	1240	25%	25%	nH/turns ²
3H3	2850	25%	25%	nH/turns ²

Accessories		
Ordering name	Description	Ordering code
CLI/P-RM8	Clip, with ground pin	432202131846

Core **RM8**

CSV-RM8-1S-12P-C	Coil former, termoset, vertical	432202107491
CSV-RM8-1S-12P-G	Coil former, termoset, vertical	432202100841
CSV-RM8-1S-4P	Coil former, termoset, vertical	432202134861
CSV-RM8-1S-5P	Coil former, termoset, vertical	432202134661
CSV-RM8-1S-8P-G	Coil former, termoset, vertical	432202101401
CSV-RM8-1S-8PL	Coil former, termoset, vertical	432202134871
CSV-RM8-1S-8P-TA	Coil former, termoset, vertical	432202102651
CSV-RM8-2S-12P	Coil former, termoset, vertical	432202134711
CSV-RM8-2S-8P	Coil former, termoset, vertical	432202134701

www.signal.com.tr