



S.ATA 7+15P Right Angle Type

Specifications

Current Rate:1.5 AMP

Insulation Resistance:1000M Ω Min

Contact Resistance:30 m Ω Max

Dielectric Voltage:500V AC for one minute

Operation Temperature:-55° C to +125° C

Material

Insulator:High temperature thermoplastic,UL 94V-0

Standard:LCP

Terminal:Copper Alloy

Plated:Selective Plaed

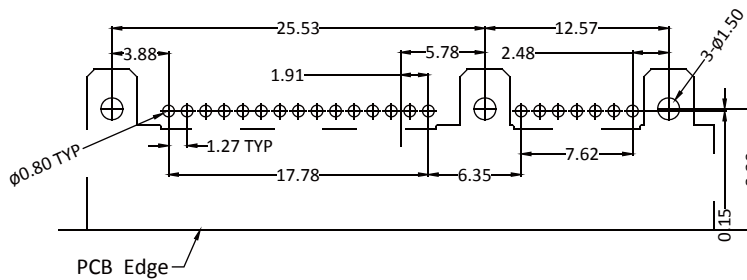
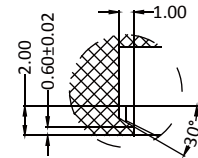
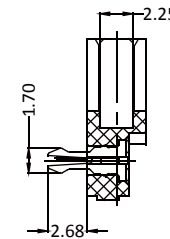
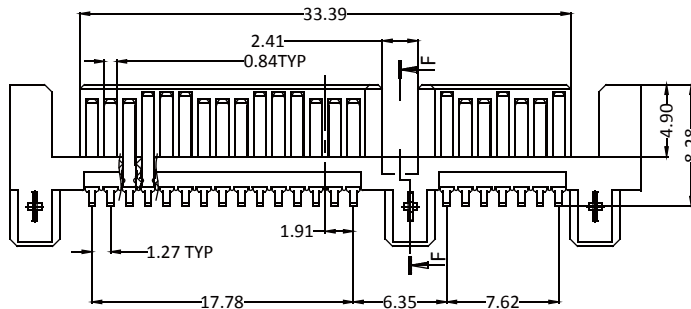
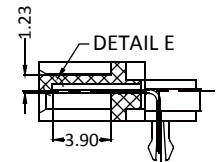
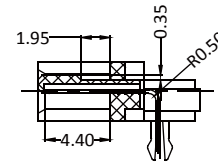
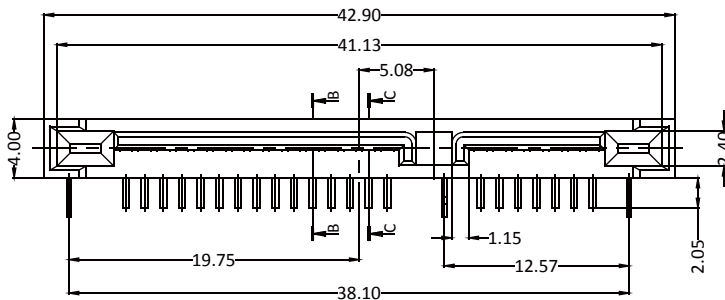
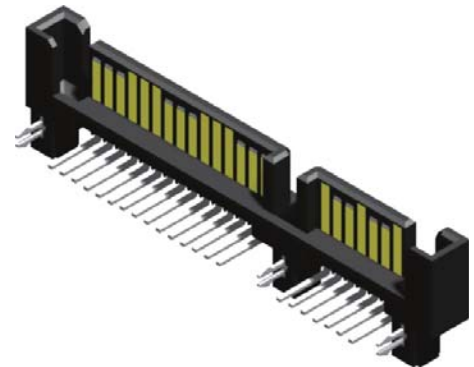

P.C.B. Layout(T=1.6mm)
TOP VIEW

SECT F-F

DETAIL E
SCALE: 10:1

Part No.:SATAR-M22SB-HB-U

ORDER INFORMATION

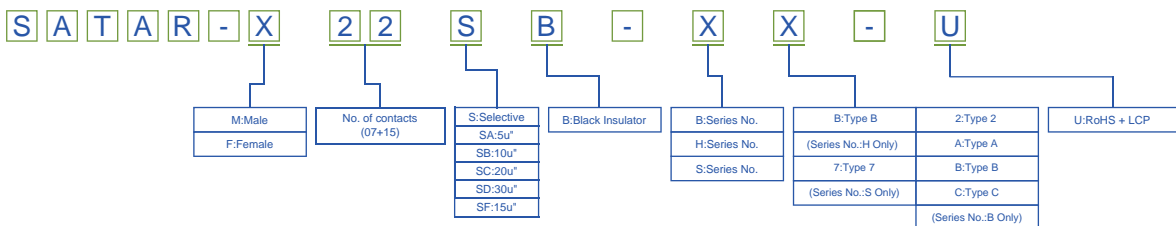

Standard Recommend