

D-SUB IDC Type

Specifications

Current Rate: 3 AMP
 Insulation Resistance: 1000MΩ Min.
 Contact Resistance: 20mΩ Max.
 Dielectric Voltage: 500V AC for one minute
 Operation Temperature: -55°C to +105°C

Material

Insulator: Polyester, UL 94V-0
 Standard: PBT
 Terminal: Copper Alloy

No. of Contacts	Dim. A	Dim. B	Dim. C	Dim. D	Dim. E	Dim. F
9	30.81	24.99	16.92	16.33	11.08	10.16
15	39.14	33.32	25.50	24.66	19.39	17.78
25	63.04	47.04	38.96	38.58	33.24	30.48
37	69.32	63.50	55.42	54.84	49.86	45.72

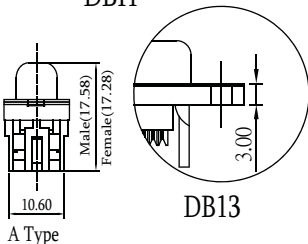
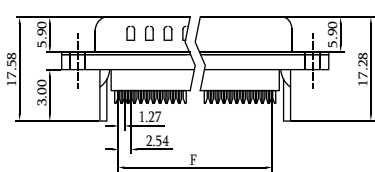
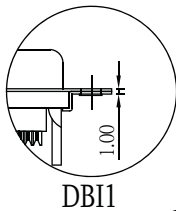
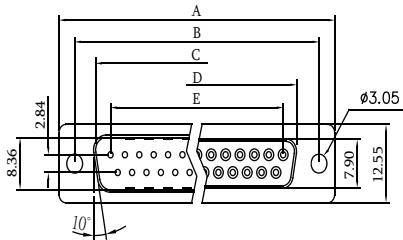

Strain Relief

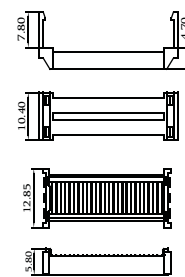

Order Information

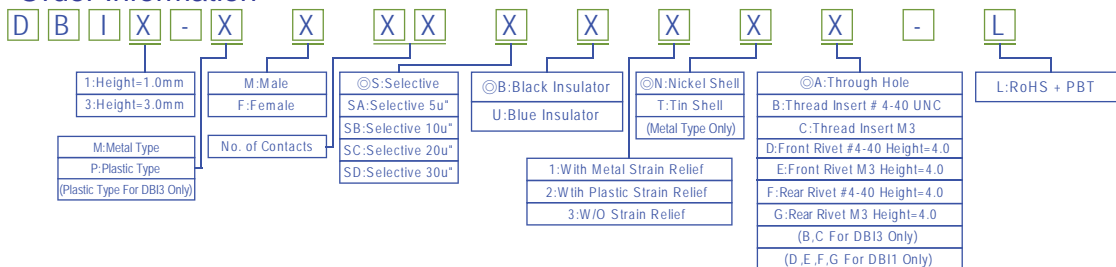

Waterproof D-SUB Right Angle Type

Specifications

Current Rate: 5 AMP
 Insulation Resistance: 5000MΩ Min.
 Contact Resistance: 10mΩ Max.
 Dielectric Voltage: AC 300V /ram 50Hz
 Operation Temperature: -55°C to +85°C

Material

Terminal: Copper Alloy.
 Insulator: PBT

No. of Contacts	Dim. A	Dim. B	Dim. C	Dim. D
9	39.40	24.99	16.92	16.33
15	47.70	33.30	25.25	24.66
25	64.50	47.04	38.96	38.38

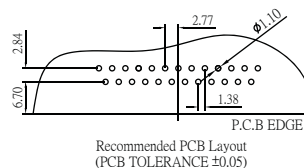
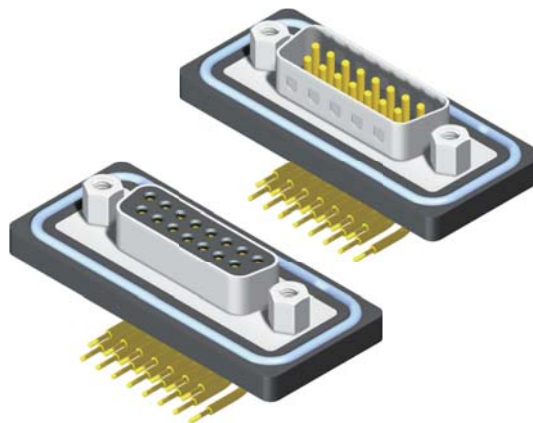
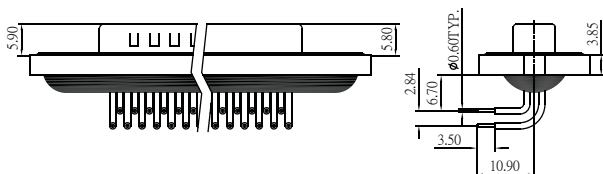
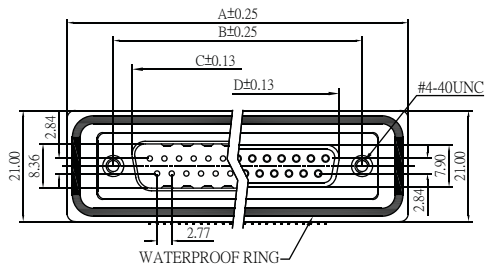

Order Information

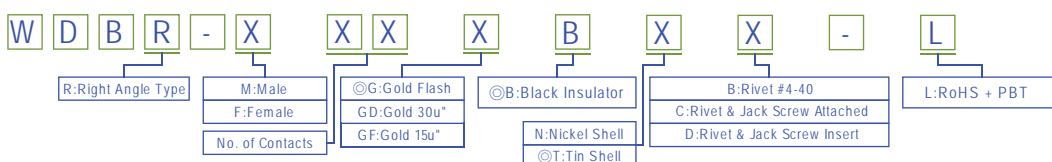

Type See Page 5-2