

Y06-2000 Current Sensor

The Y06-2000 series is a current transducer which operates on the principle of magnetic compensation. It measures DC, AC or pulse currents and their combinations, with galvanic isolation techniques used to separate the primary and secondary circuits.



Features

- Non-contact measurement of high current
- Close-Loop measurement (compensated)
- Max. measuring range $\pm 3000\text{A}$ (DC or AC peak)
- Nearly zero magnetic hysteresis
- Superior temperature stability and linearity
- High frequency bandwidth type 150kHz
- RoHs compliance (Lead-Free)

Applications

- Windmill inverters
- Single or three phase inverters
- AC variable speed drives and servo motor drives
- Energy managements
- Propulsion converters
- Static converters for DC motor drives
- Uninterruptible power supplies (UPS)
- Switched-mode power supplies (SMPS)
- Overcurrent protections
- Short circuit protections

Advantages

- Accurately measures AC, DC and pulse currents
- Fast response $< 0.5\mu\text{s}$
- High immunity from external interference
- Excellent current overload capacity

Standards

- IEC 62497-1: 2010
- EN 50155: 2021
- EN 50124-1: 2017
- EN 50121-3-2: 2016
- IEC 61010-1: 2010

Absolute maximum ratings

Symbol	Parameter	Min.	Max.	Unit
$V_{DD\ max.}$	Maximum supply voltage (not destructive)	-24	24	V
I_{PM}	Maximum measuring current	-3000	3000	A
T_A	Ambient operating temperature	-40	85	°C
T_S	Storage temperature range	-50	90	°C
$V_{ESD-HBM}$	ESD sensitivity HBM (Human Body Model)	8		kV

Stresses above these ratings may cause permanent damage. Exposure to absolute maximum ratings for extended periods may degrade reliability.

Specifications ($T_A = 25^\circ\text{C}$, $V_{DD} = \pm 24.0\text{V}$)

Symbol	Parameter	Description	Unit
V_{DD}	Supply voltage	$\pm 15 \dots 24$	V DC
I_C	Current consumption @ $I_p=0$	42 ($V_{DD}=\pm 15$) 48 ($V_{DD}=\pm 24$)	mA
I_{PN}	Current nominal measuring range	± 2000	A
I_{PM}	Maximum measuring current	± 3000	A
K_N	Conversion ratio	1:5,000	
R_S	Coil resistance @ 25°C	< 23	Ω
T_{CTOF}	Temperature coefficient of I_{OUT} @ $T_A = -40^\circ\text{C} \dots 85^\circ\text{C}$	< ± 0.01	%
T_{CIOF}	Temperature coefficient of offset @ $I_p=0$, $T_A = -40^\circ\text{C} \dots 85^\circ\text{C}$	< ± 0.3 Typical, ± 0.5 Max	mA
TEB	Full scale of I_{PN} @ $T_A = -40^\circ\text{C} \dots 85^\circ\text{C}$	< 0.4	%/ I_{PN}
ϵ_L	Non-linearity error without offset	< 0.1	%/ I_{PN}
I_{OE}	Offset current @ $I_p=0$	± 0.2 Typical, ± 0.4 Max	mA
I_{OM}	Magnetic offset current @ $I_p = 0\text{A} \rightarrow I_{PN} \rightarrow 0\text{A}$	< ± 0.2	mA
T_R	Step response to 90% of I_{PN}	< 0.5	μs
BW	Frequency bandwidth (-3dB)	150	kHz

Insulation Parameters

Symbol	Parameter	Value	Unit	Comment
V_o	Insulation voltage for isolation, 50Hz, 1 min	3500	V	
R_{ISO}	Isolation resistance @500VDC	200	M Ω	

General characteristics

Symbol	Parameter	Value	Unit	Comment
m-HSE	Housing material	V0		Flame retardant UL 94
m-FC	Flux collector material	Oriented silicon steel		Superior magnetic permeability
m	Mass	1400	grams	

Mechanical characteristics

Symbol	Parameter	Comment
INS_{VET}	Vertical position of installation	4 holes \varnothing 6.5 mm, 4 M6 steel screws, 5.5 N.m (\pm 10%)
INS_{HOR}	Horizon position of installation	4 holes \varnothing 6.5 mm, M6 steel screws, 5.5 N.m (\pm 10%)

Dimension (mm)

Y06-2000

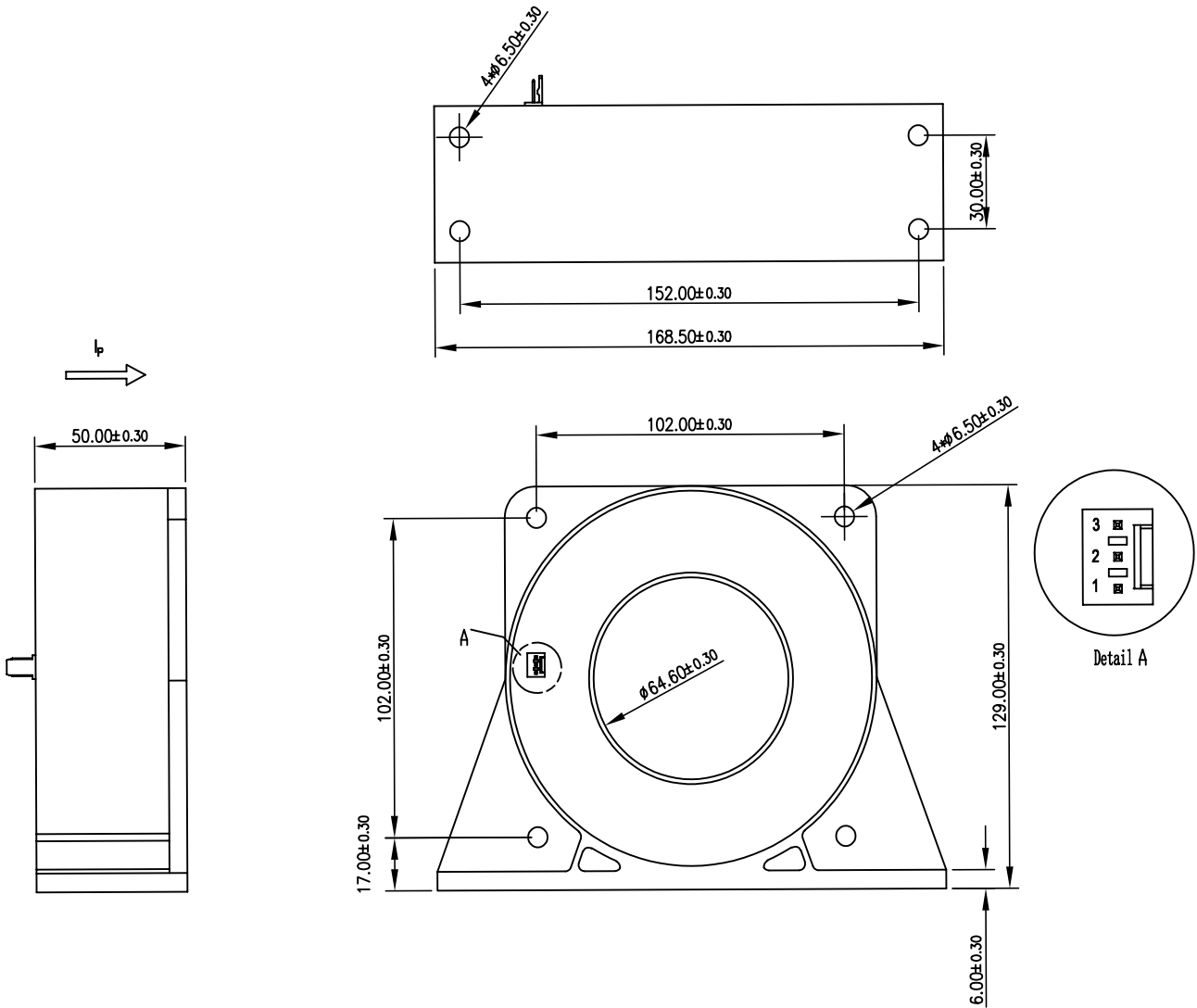

Pin	Symbol
1	$+V_{DD}$
2	V_{OUT}
3	$-V_{DD}$

Name Guide Description

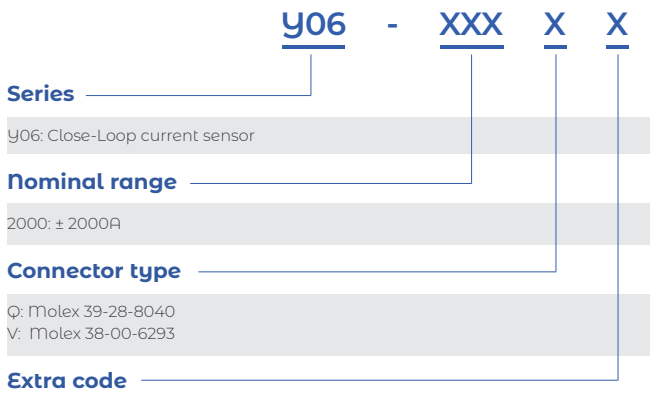

Notes

The content of this document is subject to revision without notice. Luksens shall have no liability for any error or damage of any kind resulting from the use of this document.

Safety and Environment



The product is to be installed by manufacturer trained personnel or competent person trained in accordance with manufacturer installation instructions.

With respect to applicable standards IEC 61010-1/ EN 61010-1 *safety requirements for electrical equipment for measurement, control and laboratory use part 1 general requirements*, the product should be used in limited energy secondary circuits.



Risk of electrical shock

Certain parts of the module can carry hazardous voltage during the operation process of the product because hazardous live voltage of primary conductor, power supply occurs, injury and/or serious damage will be caused if this warning is ignored.

Conducting parts must be inaccessible after installation of the product. Additional protection including shield or protective housing could be used according to IEC 60664 Insulation coordination for equipment within low-voltage supply systems.

Disconnection of the main supply will protect against possible injury and serious damage.



ESD protection

Damage from an ESD event will occur if the personnel is not well grounded when handling.

Important notice

Luksens reserves the right to make changes to or discontinue any product or service identified in this publication without notice. Luksens advises its customers to obtain the latest version of the relevant information to verify, before placing any orders. The information included herein is believed to be accurate and reliable. However, since additional design, measure, production, quality control take effect in the end product, therefore Luksens shall have no liability for any potential hazards, damages, injuries or less of life resulting from the end product.

Luksens products are not to be used in any equipment or system, including but not limited to life support equipment or systems, where failure of Luksens products may cause bodily harm.